

Name: \_\_\_\_\_

Date of birth: \_\_\_\_\_

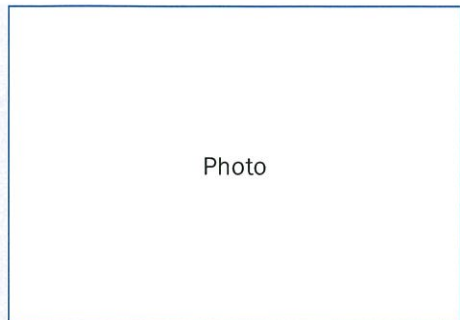

Insect allergies: \_\_\_\_\_

Other allergies: \_\_\_\_\_

Family/carer name(s): \_\_\_\_\_

Work Ph: \_\_\_\_\_

Home Ph: \_\_\_\_\_

Mobile Ph: \_\_\_\_\_

Plan prepared by: \_\_\_\_\_

Dr \_\_\_\_\_

Signed \_\_\_\_\_

Date \_\_\_\_\_

## How to give EpiPen® or EpiPen® Jr

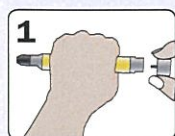

**1** Form fist around EpiPen® and PULL OFF GREY SAFETY CAP.



**2** PLACE BLACK END against outer mid-thigh (with or without clothing).

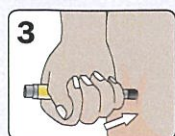

**3** PUSH DOWN HARD until a click is heard or felt and hold in place for 10 seconds.



**4** REMOVE EpiPen® and DO NOT touch needle. Massage injection site for 10 seconds.

© ASCIA 2009. This plan was developed by ASCIA

## for use with EpiPen® or EpiPen® Jr adrenaline autoinjectors

### MILD TO MODERATE ALLERGIC REACTION

- swelling of lips, face, eyes
- hives or welts

### ACTION

- **if sting can be seen, flick it out immediately (but do not remove ticks)**
- stay with person and call for help
- give medications (if prescribed) .....
- locate EpiPen® or EpiPen® Jr
- contact family/carer



**Watch for any one of the following signs of Anaphylaxis**

### ANAPHYLAXIS (SEVERE ALLERGIC REACTION)

- abdominal pain, vomiting
- difficult/noisy breathing
- swelling of tongue
- swelling/tightness in throat
- difficulty talking and/or hoarse voice
- wheeze or persistent cough
- loss of consciousness and/or collapse
- pale and floppy (young children)

### ACTION

- 1 Give EpiPen® or EpiPen® Jr**
- 2 Call ambulance\*- telephone 000 (Aus) or 111 (NZ)**
- 3 Lay person flat and elevate legs. If breathing is difficult, allow to sit but do not stand**
- 4 Contact family/carer**
- 5 Further adrenaline doses may be given if no response after 5 minutes (if another adrenaline autoinjector is available)**

### If in doubt, give EpiPen® or EpiPen® Jr

EpiPen® Jr is generally prescribed for children aged 1-5 years.

\*Medical observation in hospital for at least 4 hours is recommended after anaphylaxis.

Additional information

\_\_\_\_\_

\_\_\_\_\_